



## Waste Management Plan

### Job Details

Date: 27<sup>th</sup> November 2023  
Project: Waste Management Plan for 11 Unit Development  
Client: DeNavi Building Design  
Address: 9 Janson Place, Lilydale VIC 3140  
Planning No: TBC  
Assessor: Proud Kraturerk  
Job No: 230468

### Revision

A:	20 <sup>th</sup> June 2023	Preliminary WMP Report
B:	31 <sup>st</sup> July 2023	WMP Report
C:	27 <sup>th</sup> November 2023	Amended WMP Report per updated plan

## Introduction

The Subject site is located at 9 Janson Place. The plans prepared by DeNavi building design proposes 11 double storey units. The site has a total area of 3,703.45m<sup>2</sup> and is orientated west to east and has minimal wall on boundary construction. The driveways are proposed to the west of the development.

The purposed of this report is to determine the appropriate methods of handling and disposing waste and recycling. It is recommended each occupant received a copy to illustrate appropriate methods of waste management for correct recycling and to minimise general waste.

This report has been undertaken based on the Sustainability Victoria Best Practice Guidelines for Waste Management in Multi-Unit Development.

## Overview

### Bin Details

Bin Types & Quantity to be provided:

- 11 x 120 MGB's for general waste collected per week
- 11 x 240 MGB's for comingled recyclable waste per week

### Collection Service

The collection will be done through private collection. It is the responsibility of the Owners Corporation to organise the private collection service. The private waste contractor will enter the development in a forward motion and exit in a forward and will collect the bins in the bin area at the back of the development and at the front of the unit.

For unit 1/2/3/5/11, the bins will be picked up at the front of each unit. For unit 4/6/7/8/9/10, the bins will be collected at the back of the development (adjacent to unit 4).

## Estimated Garbage and Recycling Generation

### Residential:

Dwelling size	Garbage	Recycling
Individual dwelling	120L	120L or 240L
3 bedroom apartment or greater	120L	60L
2 bedroom apartment	100L	60L
1 bedroom or studio apartment	80L	40L

*\*Note: Taken from Guide to Best Practice for Waste Management in Multi-Unit Developments.*

Total Number of Dwelling Types	Total Rubbish Generation Rate	Total Comingled Recyclables Generation Rate
11 x Units	1320L/week	1320L/week or 2640L/week
Total	1320L/week	1320L/week or 2640L/week

## Bin Schedule and Details

### Bin Schedule and Collection Frequency:

Waste Source	Waste Stream	Bin Qty	Bin Litres	Collection Frequency
Residential	Garbage	11	120	Weekly
	Recycling	11	240	Weekly

### Bin Details:

Waste Source	Waste Stream	Lid Colour	Capacity (Litres)	Height (mm)	Width (across front, mm)	Depth (side on, mm)
Residential	Garbage	Red	120	940	485	560
	Recycling	Yellow	240	1080	580	735

The development will have a total of 22 x MGB's where 11 x 120L MGB's will be nominated for the garbage waste and 11 x 240L MGB will be nominated for the recycling waste.

## Collection Service

Collection will be undertaken by a private contractor. The contractor will be nominated for their use of a mini rear loader. The development features limited access and movability throughout the site, therefore, a mini rear loader will be ideal. Their max height is 2.1m, this will allow them to maneuver to the rear of the site. They also have a reduced turning circle, allowing them to reverse the truck to the rear of the site, then exit the subject site in a forward motion. It is the responsibility of the Owners Corporation to organise the contractor for the private waste collection.

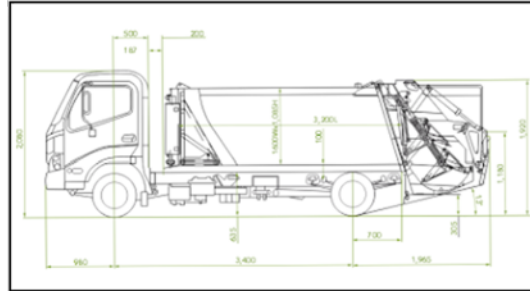

**Mini rear loader – Suitable for development with limited space**

### Onsite movability

The waste collection truck will enter the development in a forward motion, where it will collect the bins at the bin area at back of the development and at the front of the unit. The waste truck will then safely exit in a forward motion.

For unit 1/2/3/5/11, the bins will be picked up at the front of each unit. For unit 4/6/7/8/9/10, the bins will be collected at the back of the development (adjacent to unit 4).

### Private Contractors – with mini rear loaders

Waste Wise Environmental: <http://www.wastewise.com.au>

iDump: <https://idump.com.au/mini-rear-loader/> (Smaller turning circle)

# Waste Management Plan – 9 Janson Place, Lilydale VIC 3140

UNIT 1	UNIT 2	UNIT 3	UNIT 4	UNIT 5	UNIT 6	UNIT 7	UNIT 8	UNIT 9	UNIT 10	UNIT 11	COMMON AREA	TOTAL GFL
62.00 sqm	62.00 sqm	62.00 sqm	62.00 sqm	62.00 sqm	62.00 sqm	62.00 sqm	62.00 sqm	62.00 sqm	62.00 sqm	62.00 sqm	62.00 sqm	724.00 sqm
62.11 sqm	62.11 sqm	62.11 sqm	62.11 sqm	62.11 sqm	62.11 sqm	62.11 sqm	62.11 sqm	62.11 sqm	62.11 sqm	62.11 sqm	62.11 sqm	724.11 sqm
62.22 sqm	62.22 sqm	62.22 sqm	62.22 sqm	62.22 sqm	62.22 sqm	62.22 sqm	62.22 sqm	62.22 sqm	62.22 sqm	62.22 sqm	62.22 sqm	724.22 sqm
62.33 sqm	62.33 sqm	62.33 sqm	62.33 sqm	62.33 sqm	62.33 sqm	62.33 sqm	62.33 sqm	62.33 sqm	62.33 sqm	62.33 sqm	62.33 sqm	724.33 sqm
62.44 sqm	62.44 sqm	62.44 sqm	62.44 sqm	62.44 sqm	62.44 sqm	62.44 sqm	62.44 sqm	62.44 sqm	62.44 sqm	62.44 sqm	62.44 sqm	724.44 sqm
62.55 sqm	62.55 sqm	62.55 sqm	62.55 sqm	62.55 sqm	62.55 sqm	62.55 sqm	62.55 sqm	62.55 sqm	62.55 sqm	62.55 sqm	62.55 sqm	724.55 sqm
62.66 sqm	62.66 sqm	62.66 sqm	62.66 sqm	62.66 sqm	62.66 sqm	62.66 sqm	62.66 sqm	62.66 sqm	62.66 sqm	62.66 sqm	62.66 sqm	724.66 sqm
62.77 sqm	62.77 sqm	62.77 sqm	62.77 sqm	62.77 sqm	62.77 sqm	62.77 sqm	62.77 sqm	62.77 sqm	62.77 sqm	62.77 sqm	62.77 sqm	724.77 sqm
62.88 sqm	62.88 sqm	62.88 sqm	62.88 sqm	62.88 sqm	62.88 sqm	62.88 sqm	62.88 sqm	62.88 sqm	62.88 sqm	62.88 sqm	62.88 sqm	724.88 sqm
62.99 sqm	62.99 sqm	62.99 sqm	62.99 sqm	62.99 sqm	62.99 sqm	62.99 sqm	62.99 sqm	62.99 sqm	62.99 sqm	62.99 sqm	62.99 sqm	724.99 sqm
63.00 sqm	63.00 sqm	63.00 sqm	63.00 sqm	63.00 sqm	63.00 sqm	63.00 sqm	63.00 sqm	63.00 sqm	63.00 sqm	63.00 sqm	63.00 sqm	725.00 sqm

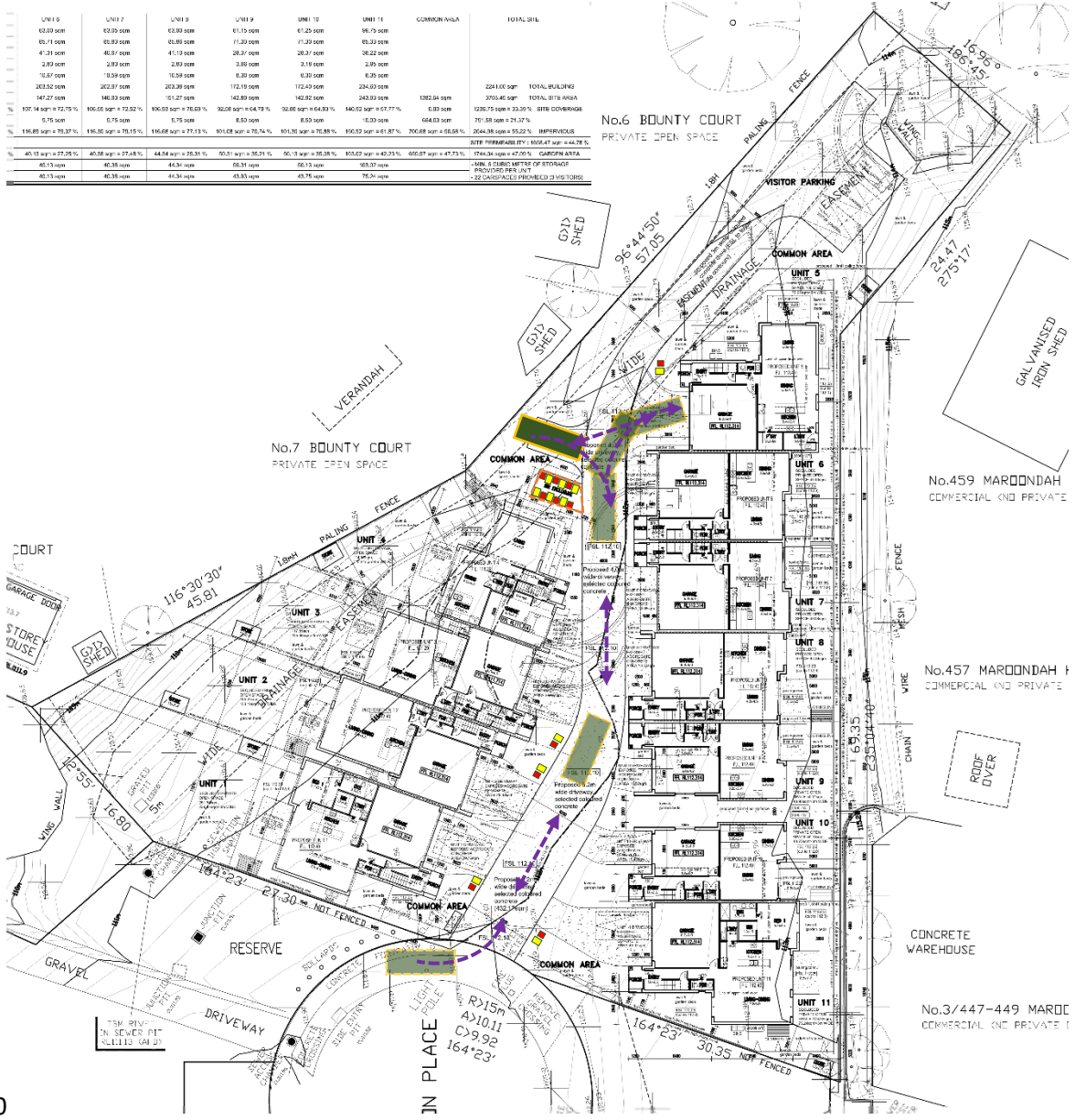

00

## Truck Collection

- Waste Truck
- Truck Route
- Bin Fencing

## Bin Storage Area

- Each unit will have 120L MGB's a garbage bin and 240L MGB's a recycling bin.
- The bins will not require to be roofed, to allow fresh air to circulate through and prevent odours from building up.
- It will be up to the residence to ensure the bin area always remains clean and well maintained . All waste and recycling should be placed in the allocated bins.

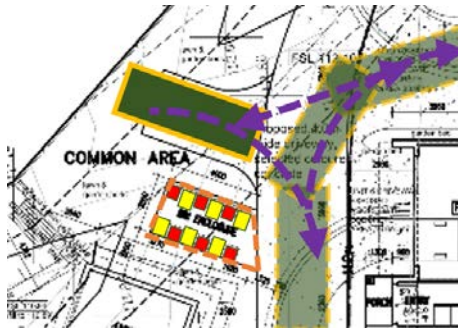

Bin storage area for unit 4/6/7/8/9/10

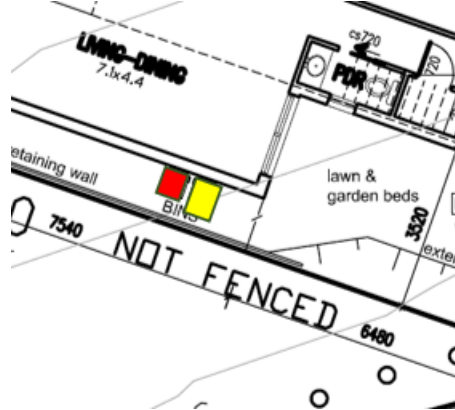

Bin storage area for unit 1/2/3/5/11

## Distribution of waste

### General Waste

The following items can be placed in garbage bin



Household Garbage



Soft plastic packaging



Food waste



Wrapped nappies and animal droppings



Polystyrene



Crockery, Pyrex glassware, mirrors, window glass (wrapped)

The following items cannot be placed in garbage bin



**No** garden waste



**No** recyclables, paper or cardboard



**No** syringes or medical waste



**No** chemicals or hazardous waste



**No** motor oil, fluids, paint or solvents















**No** building material, bricks, steel or wood

## Recycling

The following items can be placed in recycling bin.

		
Clean foil trays, empty aluminium, steel and aerosol cans	Empty glass bottles and jars	Papers, envelopes, junk mail, brochures, magazines and telephone books
		
Empty milk and juice cartons	Empty plastic bottles and containers	Cardboard boxes

The following items cannot be placed in recycling bin

		
No plastic bags	No soft plastic packaging	No recyclables in plastic bags
		
No garbage	No crockery, Pyrex or glassware	No polystyrene
		
No oil, chemicals or hazardous waste	No garden waste	No nappies
		
No building material, bricks, steel or wood	No light globes, window glass or mirrors	No clothes, linen or shoes



## Waste Prevention

### Reduce

Become informed about the environmental impacts of products. If not satisfied, search for better alternatives

Bulk buy when possible, but don't buy more than can be used

Choose products with less packaging

Choose products with recyclable or reusable packaging

Carry reusable shopping bags or boxes

Say 'no' to unnecessary plastic bags and other packaging

Re-use plastic bags and all types of containers over and over again

Buy quality goods that will last

Encourage manufacturers to play their part.

### Reuse

Look for products in reusable, refillable or recyclable packaging when shopping.

Donate unwanted clothing, furniture and white goods to charities.

Enquire if goods can be repaired rather than replaced.

Hold a garage sale.

Use rechargeable batteries rather than single-use batteries and ask the local council about how to dispose of batteries properly.

Use retreaded tyres if they are appropriate.

Use glass bottles and jars, plastic bags, aluminium foil and take away food containers over and over again before recycling or disposing of them.

Carry lunches in a reusable container rather than disposable wrappings.

Re-use envelopes and use both sides of paper.

### Recycle

Recycling generates civic pride and environmental awareness

Recycling helps prevent environmental pollution

Recycling saves natural resources

Recycling conserves raw materials used in industry

Making products from recycled ingredients often uses much less energy than producing the same product from raw materials

Recycling reduces the amount of material dumped in landfill sites

Goods are used productively and prevented from becoming litter and garbage.